



**B-SAFETY**  
PROFESSIONAL SAFETY SOLUTIONS

Article No.:

**BR 715 035D**

REV / DATE :

**09/23**

Description:

**ClassicLine hand-held eye shower with two spray heads, diagonal mounted / lab cell mounted**

Detail:

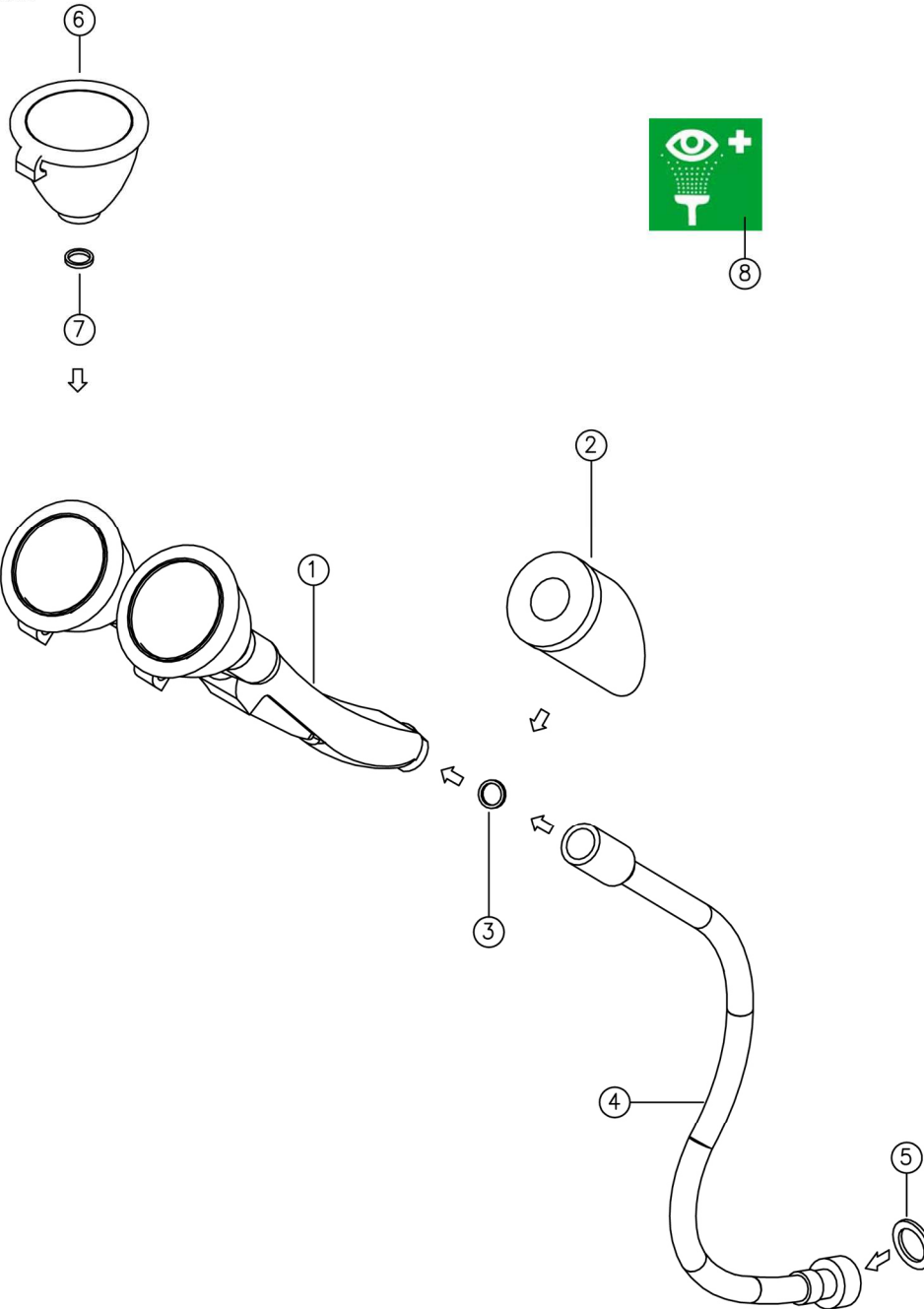

Part No.	Article No.	Quantity	Description	Material	Weight
1	F715	1	Handle with two spray heads	DZR-brass CW724R (water-bearing parts)	0.49 kg
2	BR 710 275	1	Table mounting accessories	ABS, brass	0.21 kg
3	-	1	Flat gasket (included in the hose)	EPDM	0.01 kg
4	BR 710 415	1	Stainless steel covered hose, 1500 mm	Stainless steel AISI 304, brass	0.31 kg
5	-	1	Flat gasket (included in the hose)	EPDM	0.01 kg
6	BR 710 600	2	High-performance spray head	POM Hostaform C13021, EPDM	0.06 kg
7	96B001	2	Stainer gasket	Stainless steel AISI 304, TPE	0.01 kg
8	BR 205 010	1	Emergency sign, 100 x 100 mm	PVC film, self-adhesive	0.01 kg
-	97B-RUECK	1	Backflow preventer	POM, silicone	0.01 kg
-	97B14	1	Flow regulator 14 l/min (blue)	POM, EPDM	0.01 kg