

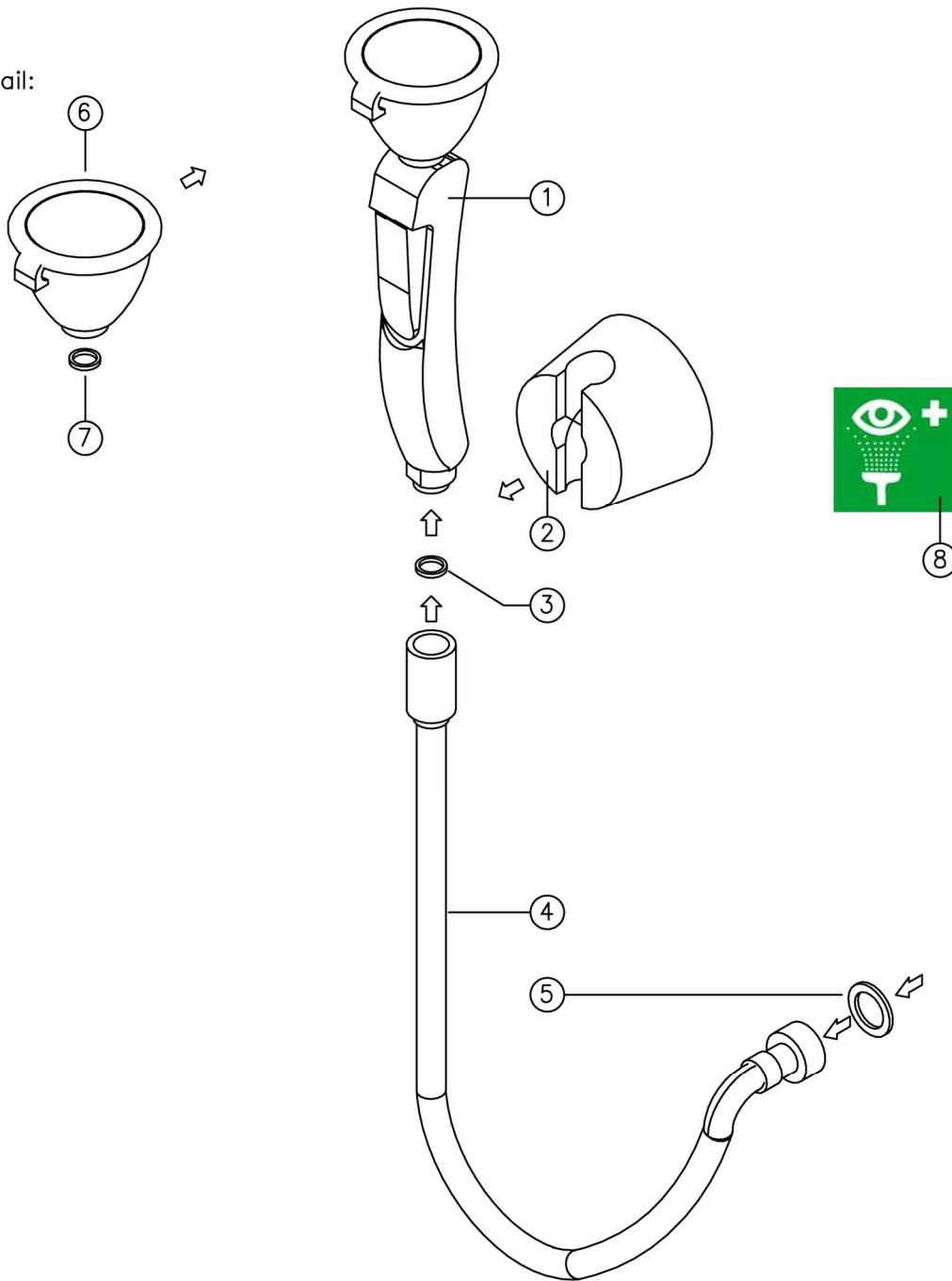

Detail:



| Part No. | Article No. | Quantity | Description | Material | Weight |
|----------|-------------|----------|---------------------------------------|--|---------|
| 1 | F712 | 1 | Handle with one spray head | DZR-brass CW724R (water-bearing parts) | 0.36 kg |
| 2 | BR 710 250 | 1 | Table mounting accessories | ABS, brass | 0.24 kg |
| 3 | - | 1 | Flat gasket (included in the hose) | EPDM | 0.01 kg |
| 4 | BR 710 415 | 1 | Stainless steel covered hose, 1500 mm | Stainless steel AISI 304, brass | 0.31 kg |
| 5 | - | 1 | Flat gasket (included in the hose) | EPDM | 0.01 kg |
| 6 | BR 710 600 | 1 | High-performance spray head | POM Hostaform C13021, EPDM | 0.06 kg |
| 7 | 96B001 | 1 | Stainer gasket | Stainless steel AISI 304, TPE | 0.01 kg |
| 8 | BR 205 010 | 1 | Emergency sign, 100 x 100 mm | PVC film, self-adhesive | 0.01 kg |
| - | 97B-RUECK | 1 | Backflow preventer | POM, silicone | 0.01 kg |
| - | 97B07 | 1 | Flow regulator 7 l/min (green) | POM, EPDM | 0.01 kg |