



B-SAFETY
PROFESSIONAL SAFETY SOLUTIONS

Article No.:

BR 088 085D

REV / DATE :

08/22

Description:

ClassicLine body safety shower with pull rod diversion, above door installation

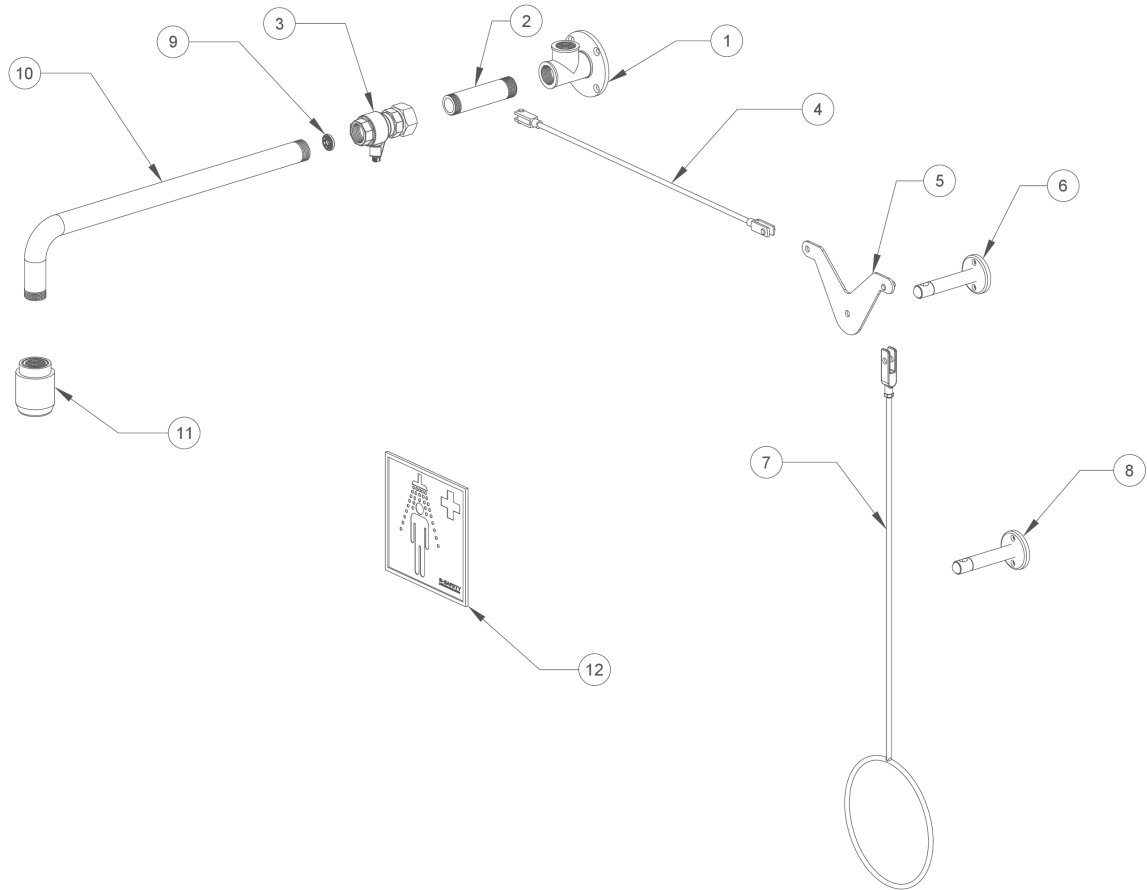

Part No.	Article No.	Quantity	Description	Material	Weight
1	F81701	1	Wall flange 2-fold, green	Stainless steel AISI 304	0.47 kg
2	F81301	1	Connection pipe, green	Stainless steel AISI 304	0.12 kg
3	F8271	1	Ball valve with lever for over-door mounting, green	Dezincification-resistant brass CW724R, stainless steel AISI 201	0.38 kg
4	C77-085-S	1	Linkage for pull rod diversion, green	Galvanised steel	0.14 kg
5	C77-085-1	1	V-Angle for pull rod diversion, green	Stainless steel AISI 201	0.19 kg
6	C77-085-2	1	Wall bracket, green	Galvanised steel	0.20 kg
7	F801-085	1	Pull rod, green	Stainless steel AISI 201	0.41 kg
8	F81901-80	1	Pull rod holder, green	Stainless steel AISI 201, AISI 304	0.16 kg
9	97BXX	1	Flow regulator 97B50 = 50 l/min (red) or 97B75 = 75 l/min (brown)	POM Hostaform C9021	0.01 kg
10	F81101	1	Bent pipe, green	Stainless steel AISI 304	0.94 kg
11	BR 010 365	1	High-performance shower head, black	POM Hostaform C13021	0.10 kg

12	BR 205 105	1	Emergency sign, 150 x 150 mm	PVC film, self-adhesive	0.01 kg
----	------------	---	------------------------------	-------------------------	---------