



B-SAFETY
PROFESSIONAL SAFETY SOLUTIONS

Article No.:

BR 085 085D

REV / DATE :

08/22

Description:

ClassicLine body safety shower, ceiling mounted, exposed pipework

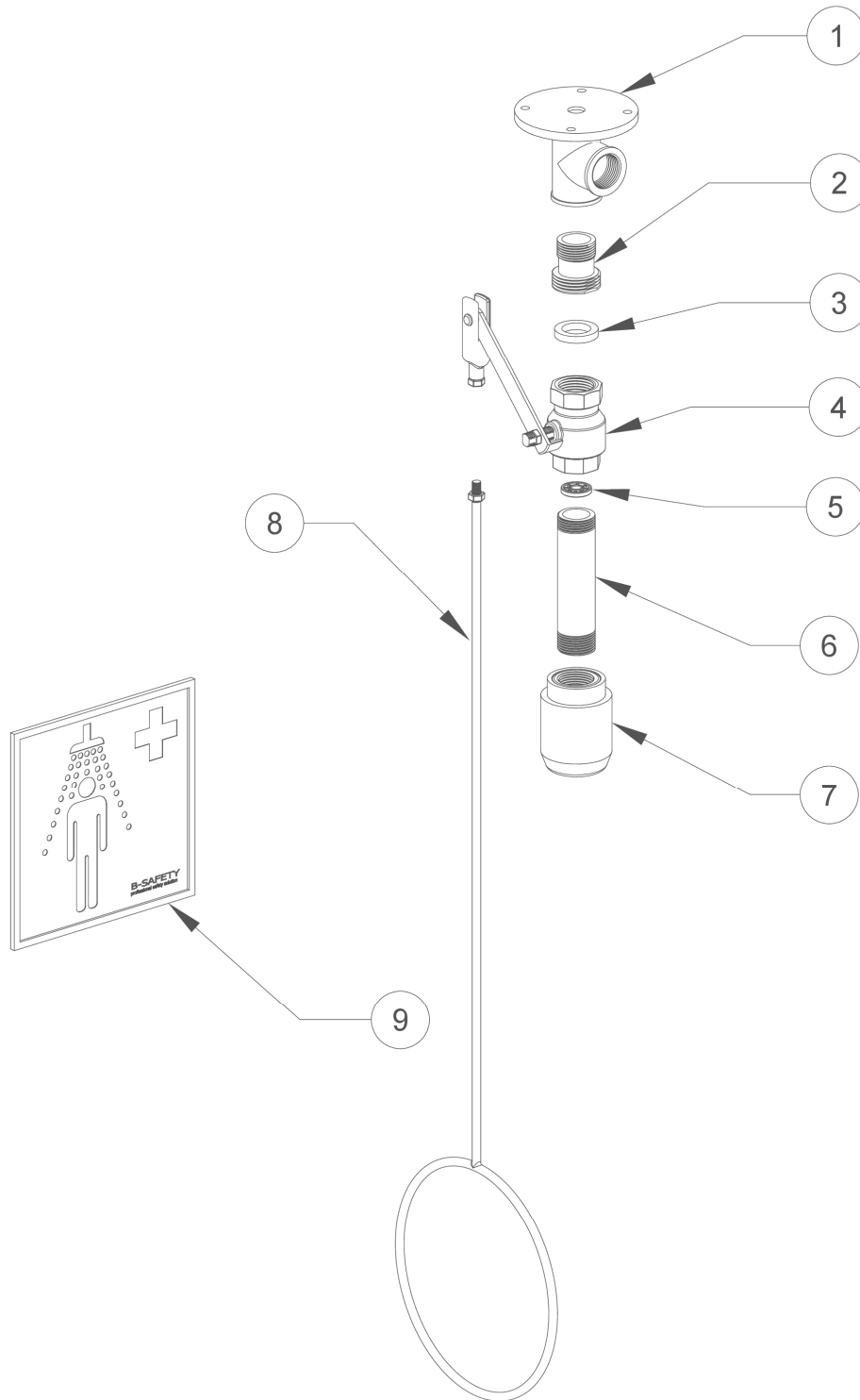

Part No.	Article No.	Quantity	Description	Material	Weight
1	F81701	1	Ceiling flange 2-fold, green	Stainless steel AISI 304	0.47 kg
2	XN1	1	Adapter XN1	Stainless steel AISI 304	0.06 kg
3	150040100	1	Gasket	Vulcan fiber	0.01 kg
4	F8277	1	Ball valve with lever and quick mounting system	Dezincification-resistant brass CW724R, stainless steel AISI 201	0.38 kg
5	97BXX	1	Flow regulator 97B50 = 50 l/min (red) or 97B75 = 75 l/min (brown)	POM Hostaform C9021	0.01 kg
6	F81301	1	Connection pipe, green	Stainless steel AISI 304	0.12 kg
7	BR 010 365	1	High-performance shower head, black	POM Hostaform C13021	0.10 kg
8	F801-085	1	Pull rod, green	Stainless steel AISI 201	0.41 kg
9	BR 205 105	1	Emergency sign, 150 x 150 mm	PVC film, self-adhesive	0.01 kg