



B-SAFETY[®]
PROFESSIONAL SAFETY SOLUTIONS

Article No.:

BR 082 095D

REV / DATE :

08/22

Description:

**PremiumLine body safety shower, wall mounted,
exposed pipework**

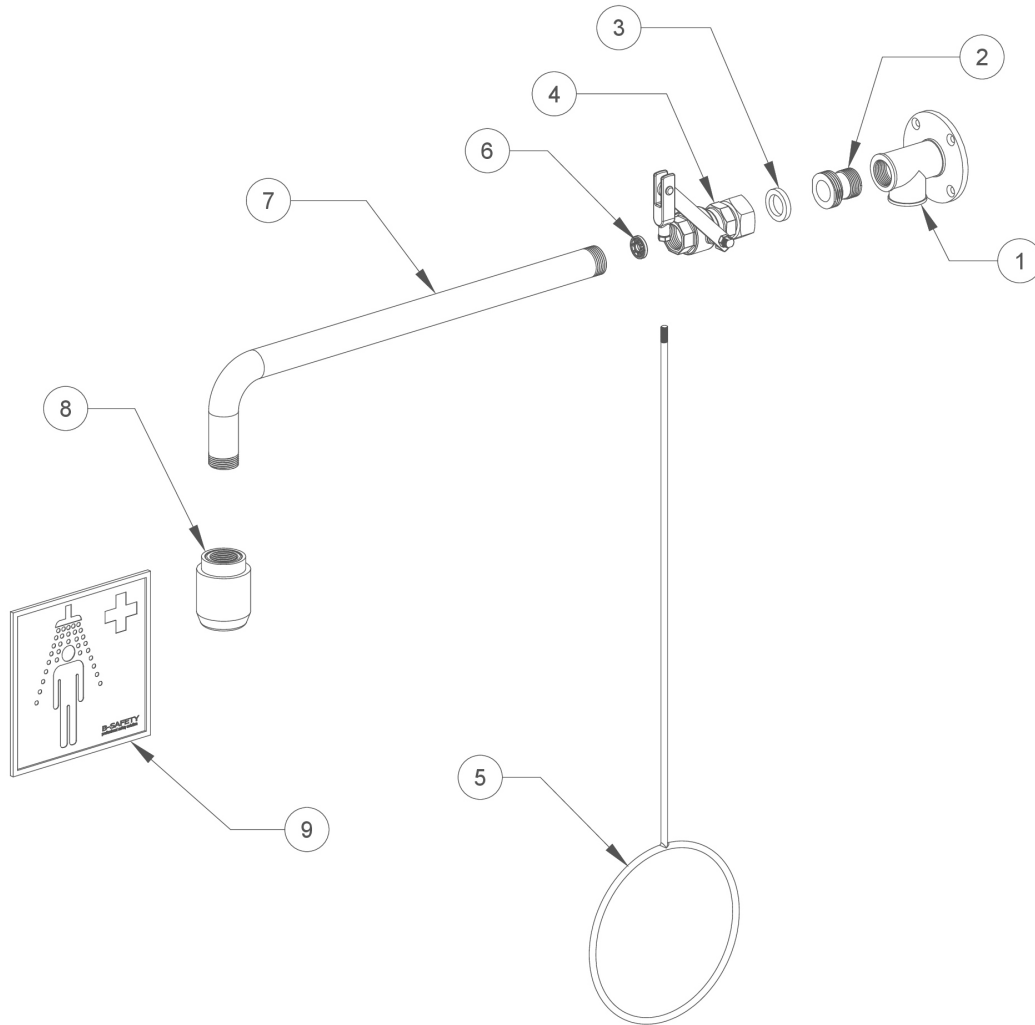

Part No.	Article No.	Quantity	Description	Material	Weight
1	F81703	1	Wall flange 2-fold, stainless steel	Stainless steel AISI 316	0.47 kg
2	XN1	1	Adapter XN1	Stainless steel AISI 316	0.06 kg
3	150040100	1	Gasket	Vulcan fiber	0.01 kg
4	F8276	1	Ball valve with lever and quick mounting system	Stainless steel AISI 316	0.38 kg
5	F801-095	1	Pull rod, stainless steel	Stainless steel AISI 316	0.41 kg
6	97BXX	1	Flow regulator 97B50 = 50 l/min (red) or 97B75 = 75 l/min (brown)	POM Hostaform C9021	0.01 kg
7	F81103	1	Bent pipe, stainless steel	Stainless steel AISI 316	0.94 kg
8	BR 010 395	1	High-performance shower head, stainless steel	Stainless steel AISI 316	0.62 kg
9	BR 205 105	1	Emergency sign, 150 x 150 mm	PVC film, self-adhesive	0.01 kg